



HC28

Nominal Technical Specifications



HC series is especially used for engine starting, which requires superior cranking performance at lower temperatures, for high current discharge.

Nominal Capacity	
20 Hour Rate	28AH

Reserve Capacity			
Reserve@25 Amps	48Min	Reserve@75 Amps	6Min

Electrical Specifications	
Nominal Voltage	12 Volt
C20	28 AH
C5	24 AH
CCA	410 A
CA or MCA	530 A
HCA	625 A
PHCA	925 A
Short Circuit Current	1382 A
Internal Resistance	9.1 mΩ
Self-Discharge@25°C	≤ 3% per month

Mechanical Specifications		
Group Size	N/A	
Terminal Type	M8- Button Terminal	
Terminal Torque	62~80 in-lbs	
Height(w/terminal)	125 mm	4.92"
Height(case only)	125 mm	4.92"
Width	176 mm	6.93"
Length	165 mm	6.50"
Weight	10.7 Kg	23.59 lbs.
Case Type	ABS Plastic- Flame Res. Rating UL94-HB	

Operational Data	
Operating Temperature	-4°F to 122°F (-20°C to +50°C). At temperatures below 32°F (0°C) maintain a state of charge greater than 60%.

Charging Instructions	
Maximum Charge Current (A)	25% of C ₂₀
Absorption Voltage	14.4V-14.7V
Float Voltage	13.5V-13.8V

PHYSICAL CHARACTERISTICS

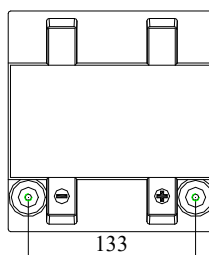
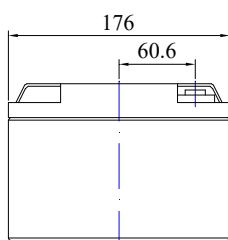
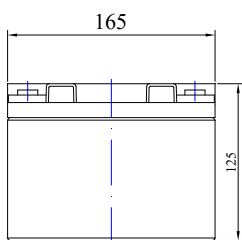

Terminal Type: M8:

unit:mm

