

EXIDE® Batteries

Revision No. 00
Release Date: May 2025



42 Months Warranty*

*for PRIVATE passenger vehicle use, subject to terms and conditions

PART NUMBER	XDIN44MF	
CHARACTERISTIC	Lead-Acid Sealed Maintenance Free	
GROUP SIZE	LB2/DIN55	
CASE AND LID	Material	Polypropylene (PP)
	Handle	1-pc PP handle
	Case Colour	Black Casing
	Lid Colour	Blue Lid
	Ledge / Hold-down	Recessed ledge on all sides
Vent	Centralized venting	

DIMENSIONAL SPECIFICATIONS

OVERALL DIMENSIONS	METRIC (mm)
LENGTH	214
WIDTH	175
HEIGHT (bottom to top cover)	175
TOTAL HEIGHT (bottom to top of terminal)	175
NOMINAL WEIGHT	12.26 kg

TERMINAL DATA	POSITIVE	NEGATIVE
TYPE	SAE	SAE
TERMINAL HEIGHT (mm)	18.5±1.50	18.5±1.50
BOTTOM DIAMETER (mm)	19.5+0/-0.3	17.5+0/-0.3
TAPER	1:9	1:9
POLARITY		

TECHNICAL SPECIFICATIONS

COLD CRANKING AMPS (CCA)	510 CCA
	Test reference: AS60095.1: 2022 Rated CCA DCH at 18°C for 30 sec
CAPACITY (RC)	75 mins
	Test reference: AS60095.1: 2022 25 Amps DCH at 10.5 V cut-off voltage

AMPERE-HOUR (20-HOUR CAPACITY)	50 AH
	Test reference: AS60095.1: 2022
	Rated AH DCH at 10.5 V cut-off
PLATE DESIGN	Lead-Calcium Alloy Full Frame Plate Design
ELECTROLYTE	36% H ₂ SO ₄ at 15°C

TOP VIEW

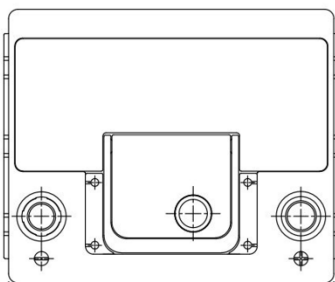

FRONT VIEW

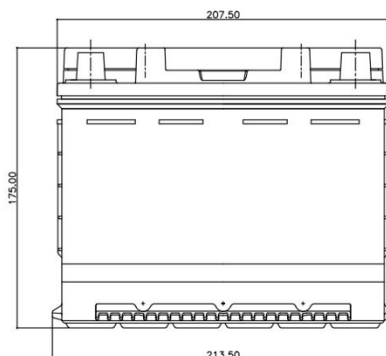

SIDE VIEW

